

MV SUPPLY CHAIN SOLUTIONS

RFID Hanging Garment Tunnel

High Speed Logistics

Checkpoint's Merchandise Visibility Solutions, provide retailers with crucial insight into the accuracy of quantities and the locations of their merchandise from the source to the store. The RFID Hanging Garment Tunnel provides these capabilities by rapidly reading RFID encoded hanging garments prepared for distribution, which in turn integrates RFID at the point of manufacture, and provides real-time tracking capabilities through order fulfillment, logistics, distribution operations and throughout recipients store locations when additional RFID components and software are utilized.

The RFID Hanging Garment Tunnel solution is designed to read RFID tagged hanging garments, and integrate seamlessly into the DC Operations/Manufacturing Plant with minimal modifications or impact to production and line speeds. The Hanging Garment Tunnel can accommodate line speeds up to 92 feet per minute, with a packing density of 450 items spaced at 3.3 feet apart, and supports throughput of up to 110,000 hanging items per hour.

Checkpoint RFID Hanging Garment Tunnels are equipped with the following standard components:

- Proprietary Checkpoint reader with Wirama technology antennas.
- RF shielding, which eliminates both noise and stray RFID tag reads.
- Sensors, for an individual bundle, trolley or block detection.
- Mounting supports for mounting the Hanging Garment Tunnel direct to the manufacturing floor.



RFID Hanging Garment Tunnel



MECHANICAL SPECIFICATIONS

	Length (in)	Width (in)	Height* (in)	Weight (lb)
RFID Hanging Goods Read Station	42.2	55.6	92.8 - 106.5	275
RFID Hanging Goods Passive Station	41.3	52.2	92.8 - 106.5	253



PERFORMANCES

	Max. Speed	Garments per Bundle	Distance Between Bundles
RFID Hanging Goods Read Station	121 f/m	min 1 - max 16	1.3 ft Garments 2 ft Hangers
RFID Hanging Goods Passive Station	121 f/m	min 1 - max 15	1.3 ft Garments 2 ft Hangers



FREQUENCIES

ETSI 865.6 - 867.6 Mhz

PROTOCOL

ISO 18000-6C

EPC Class 1 Gen 2



ELECTRICAL SPECIFICATIONS

Input Voltage: 100-240 V; 50/60 Hz; 0,5-0,25A, internal Fuse D4A.

The supply voltage must include a mains socket with a fuse of C10A or higher.



ENVIRONMENT SPECIFICATIONS

Operating Temperature	41 to 113 °F
Storage Temperature	-4 to 149 °F
Relative Humidity	5% to 95% non-condensing

RFID HANGING GARMENT TUNNEL READ STATION

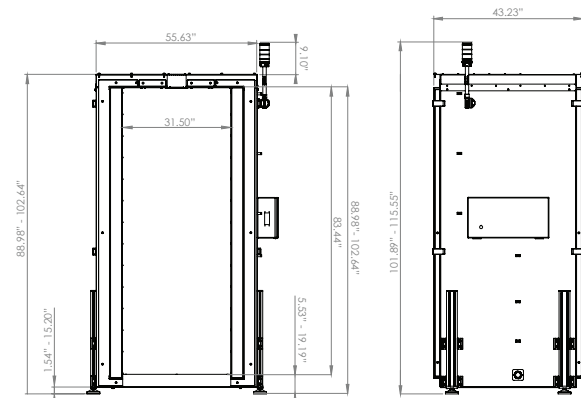

RFID HANGING GARMENT TUNNEL PASSIVE STATION

